

9:00 – 9:25

Urban Concept Car

James Back, Evan Curtis, Dan Jackson, Mark Johnson and Eric Lindamood
Advisor: Dr. Junghsen Lieh



9:25 – 9:50

Human Powered Vehicle
“Reverse Pedal”

Ethan Anderson, Dillon Jameson Jordan Speers and Jennifer Toney
Advisor: Dr. Junghsen Lieh



9:50 – 10:15

Hybrid UAV

Mosaed Alajmi, Zain Alqattan, Dakota Hardin, Christopher Hiatt and Dustin Lutz
Advisor: Dr. Junghsen Lieh

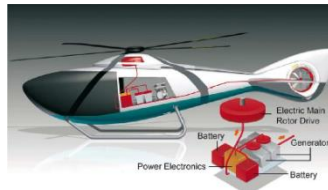

10:15 – 10:45 Break (Demonstrations)

10:45 – 11:10

Push-Pull Wheelchair

Mohammad Alboti, Meshaal Alqaseer, Husain Esmaeel and Morgan King
Advisor: Dr. Junghsen Lieh



11:10 – 11:35

Human Powered “All Limb” Vehicle

Ahmed Alhalal, Hamad Almadhi, Khalifa Almansouri and Mutaz Mohammadhussain
Advisor: Dr. Junghsen Lieh



11:35 – 12:00

Additive Manufacturing

Brad Buxton, Caitlin Sherman, Jeremy Lee and Brandon Pfladderer
Advisor: Dr. Ahsan Mian

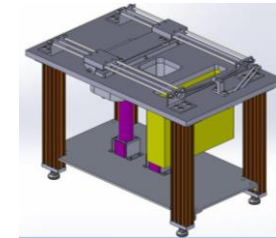

12:00 – 1:30 Lunch (Demonstrations)

1:30 – 1:55

Solar Desalination

Travis Tidball, Mackenzie Kirby, Patrick Morrissey and Phuoc Nguyen
Advisor: Dr. Jim Menart



1:55 – 2:20

Inflatable Wing Design

Brandon Burdette, Zac Ganger, Rachel Sharp and Brandon Wehner
Advisor: Dr. Rory Roberts



Senior Design Presentations
2014-2015 ME 4910/4920
9:00 AM – 2:30 PM
April 25, 2015 (Saturday)

Session MME 2
145 Russ Engineering Center



9:00 – 9:25

All Solid State Li-ion Batteries

Andrew Aliff, Laura Gliebe, Barbara Lucarelli, Ian Wolford
Advisor : Dr. Hong Huang



11:10 – 11:35

Human Powered Lawn Mower

Aaron Eilerman, Craig Feehan, Eric Fischer, Abdullah Marafi
Advisor : Dr. Junghsen Lieh



9:25 – 9:50

AFRL Design Challenge

Miranda Beyer, Curisha Drafton, Conner Osowski, Michael Pelfrey, Luke Sheridan
Advisor: Dr. Scott Thomas



11:35 – 12:00

Human Power Vehicle

Emily Dixon, Benjamin Mainwaring, Omar Sultan, Andrew Turner
Advisor: Dr. Junghsen Lieh



9:50 – 10:15

NASA ICED

Nathan Blair, Jessica Bohn, Lauren Kesler
Advisor: Dr. Ha-Rok Bae

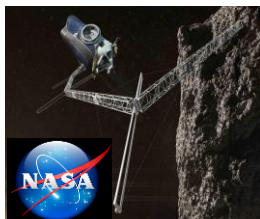

12:00 – 1:30 Lunch (Demonstrations)

1:30 – 1:55

Quarter Scale Tractor

John McDermott, Kevin Nielsen, Nathaniel Smith
Advisor: Mr. Dennis Hance

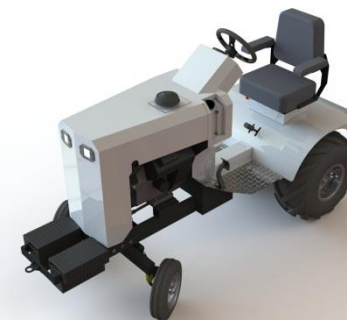

10:15 – 10:45 Break (Demonstrations)

10:45 – 11:10

Cardboard Bicycle Design

Ali Abul, Abdullah Albaghli, Andrew Staley, Casey Spinks
Advisor : Dr. Ha-Rok Bae



Senior Design Presentations
2014-2015 ME 4910/4920
9:00 AM – 2:30 PM
April 25, 2015 (Saturday)

Session MME 3
144 Russ Engineering Center



9:00 – 9:25

NASA Lunar Mining Robot

Harsha Bulathsinghalage, Ben Cook, Kathy Charpie and Marc Potts

Advisor: Dr. Scott Thomas



9:25 – 9:50

F-16

Jack Young, Mark Moore, Robert Buettner, James McBean

Advisor: Dr. Mitch Wolff



9:50 – 10:15

APOP – Methane Fueled Jet

Michelle Harr, Clint Hirtzinger, Daniel Reilly, Eric Tipps and Tyler Weihing

Advisor: Dr. Rory Roberts



10:15 – 10:45 Break (Project Demonstrations)

10:45 – 11:10

Power Plant Carbon Capture

Rashed Alazemi, Andrew Foose and Fahad Alajmi

Advisor: Dr. Rory Roberts



11:10 – 11:35

Solar Concentrator

Katy Hitchcock, Alex Henz, Kelsey Fruchey and Justin Ryan

Advisor: Dr. Jim Menart



11:35 – 12:00

NASA Human Rover Challenge

Mohammed Abdeen, Qassim Alhakeem, Joe Demboski, Ryan Heil and Clinton Krakowiak

Advisor: Dr. Junghsen Lieh



12:00 – 1:30 Lunch (Project Demonstrations)

1:30 – 1:55

Reverse Pedaling Bike

Samuel Foskuhl, Jesus Romo and Paul Wade

Advisor: Dr. Junghsen Lieh



1:55 – 2:20

Shell Eco-Car

Hamad Alhajri, Adam McMahon, Jonathan Staton and Justin Storrer

Advisor: Dr. Junghsen Lieh



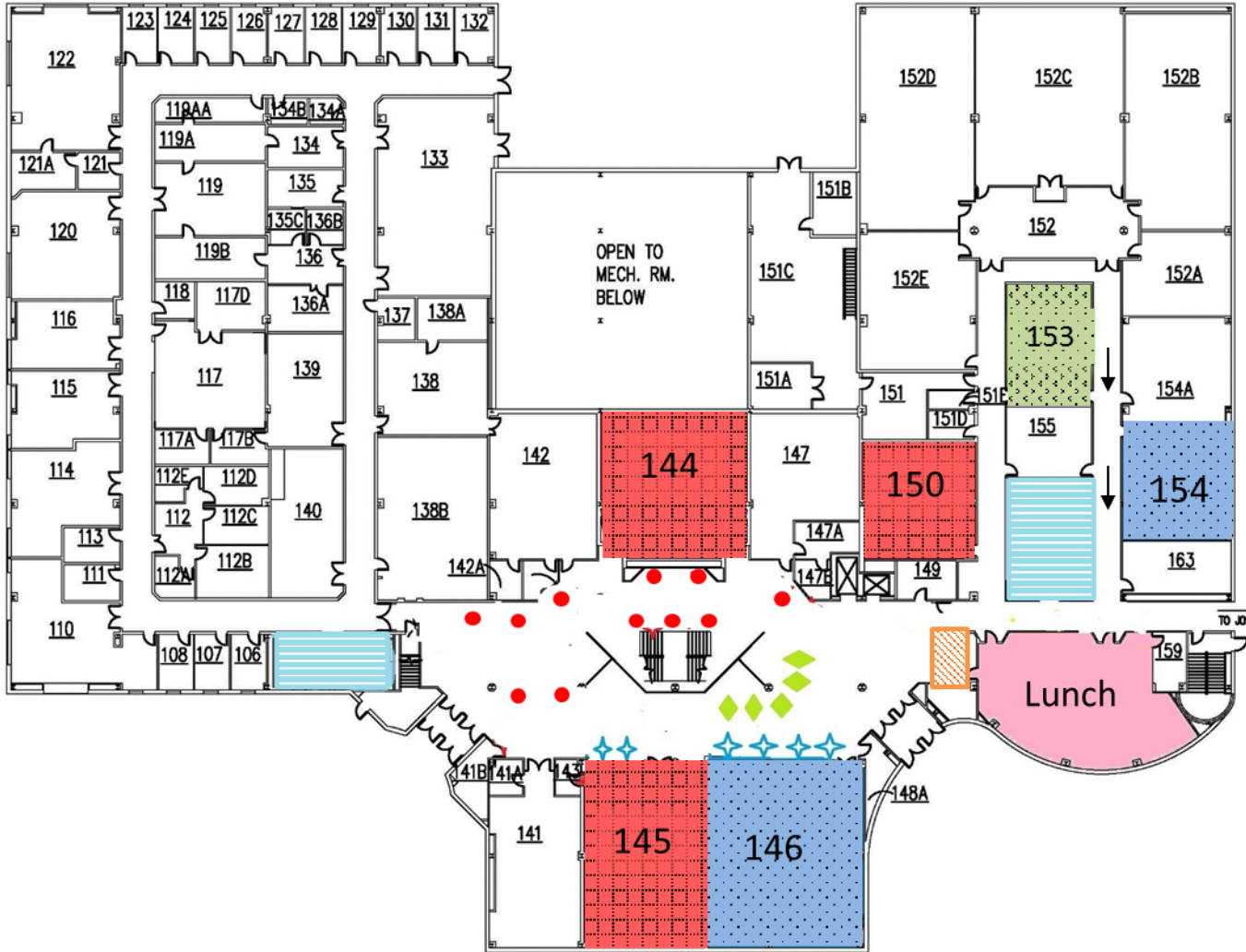
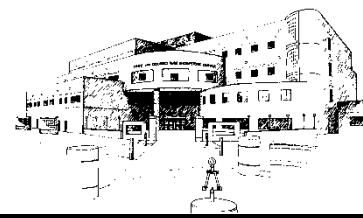

MME Presentations

BIE Presentations

ISE Presentations

● MME Tables

★ BIE Tables

◆ ISE Easels

Information & Tickets

Lunch

Restrooms

WRIGHT STATE UNIVERSITY					
Engineering & Construction Department (937) 775-2587 - construction@wright.edu					
RUSS ENGINEERING CENTER					
FLOOR PLAN - FIRST FLOOR					
RC - 0123					
BY	DATE	SCALE	SEQUENCE	DWG#	REVISION
D. KENDRICK	10/02/2012	1"=30'	2 / 6	2875	4/24/2013

E:\p-m-restricted\12-RSU-Floor-Plans\Russ Engineering\Russ Engineering-1.dwg